







BMT85

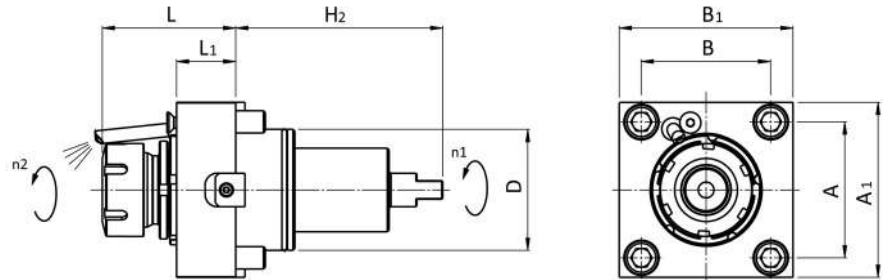

BMT85	Version	Tools Clamping	Center Height	Max. speed	Ratio	External	Internal	Page
	0°	ER50 - DIN6499		3200rpm	i=1:1	RAPPS 50 121UT85	RAPPS 50 131UT85	4
	90°	ER50 - DIN6499 ER50 - DIN6499 Ø27mm - DIN6358 Ø27mm - DIN6358	85mm 110mm 85mm 110mm	3200rpm 3200rpm 3200rpm 3200rpm	i=1:1 i=1:1 i=1:1 i=1:1	RRPPS 50 121UT85 RRPPS 50 321UT85 RRPFS 27 121UT85 RRPFS 27 321UT85	RRPPS 50 131UT85 RRPPS 50 331UT85	5 5 6 6







BMT85	Version	Tools Clamping	Center Height	Coolant	ALGRA Part No.	Page
	O.D. cutting holder	□ 32mm	H:135mm	External	E10/U 32 T85X135	7
		□ 1.25"	H:135mm	External	E10/U 1.25" T85X135	7
	Face and I.D. cutting holder	□ 32mm	H:72mm	External	E10/UA 32 T85X72	7
		□ 1.25"	H:72mm	External	E10/UA 1.25" T85X72	7
	Boring Bar holder	∅ 60mm	H:95mm	Int/Ext	E10/B 60 T85X95	8
		∅ 2.5"	H:95mm	Int/Ext	E10/B 2.5" T85X95	8

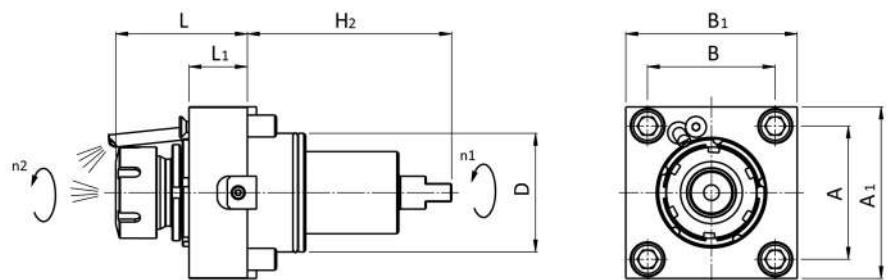
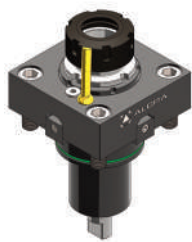





1/BMT85			Codice	D	ER	H	H1	H2	L	L1	L2	A	B	A1	B1	A2	B2	M ₂	n ₂	P
			code - code - Bestell Nr.						(min-max)									Nm	min-1	kW
  			RAPPS 50 121UT85	85	50			140	112-119,2	46,5		100	100	125	125			150	3200	15
																				

4

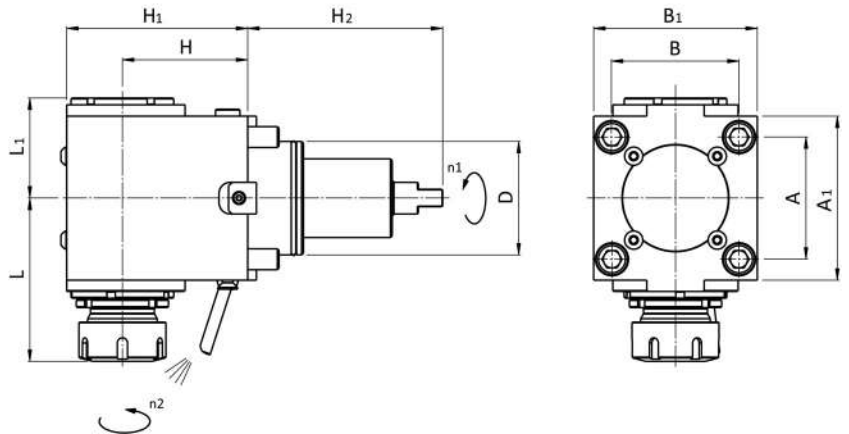





2/BMT85			Codice	D	ER	H	H1	H2	L	L1	L2	A	B	A1	B1	A2	B2	M ₂	n ₂	P
			code - code - Bestell Nr.						(min-max)									Nm	min-1	kW
  			RAPPS 50 131UT85	85	50			140	112-119,2	46,5		100	100	125	125			150	3200	15
  																				

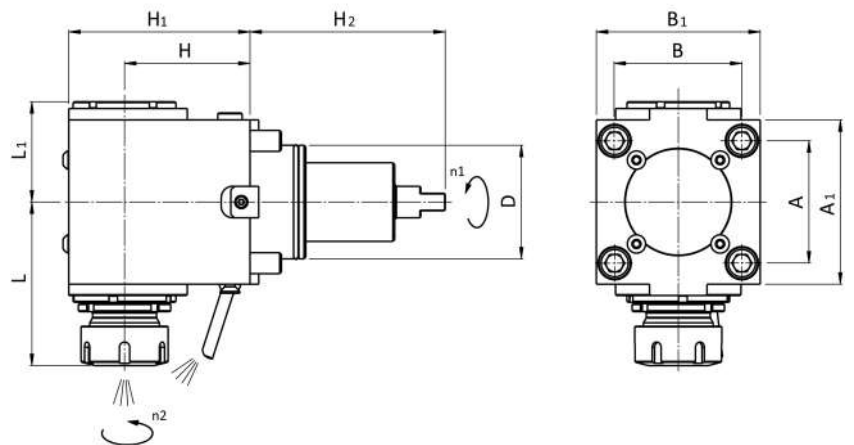



3/BMT85			Codice	D	ER	H	H1	H2	L	L1	L2	A	B	A1	B1	A2	B2	M ₂	n ₂	P	
			code - code - Bestell Nr.						(min-max)									Nm	min-1	kW	
90°			RRPPS 50 121UT85	85	50	85	136,5	140	140,3÷147,7	91,6		100	100	125	125			150	3200	15	
			RRPPS 50 321UT85	85	50	110	161,5	140	140,3÷147,7	91,6			100	100	125	125			150	3200	15
																					



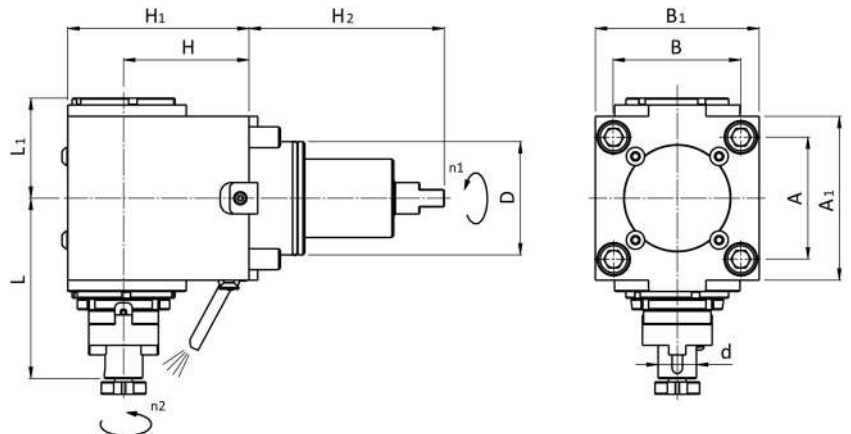

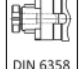
4/BMT85			Codice	D	ER	H	H1	H2	L	L1	L2	A	B	A1	B1	A2	B2	M ₂	n ₂	P	
			code - code - Bestell Nr.						(min-max)									Nm	min-1	kW	
90°			RRPPS 50 131UT85	85	50	85	136,5	140	140,3÷147,7	91,6		100	100	125	125			150	3200	15	
			RRPPS 50 331UT85	85	50	110	161,5	140	140,3÷147,7	91,6			100	100	125	125			150	3200	15
																					
																					
																					



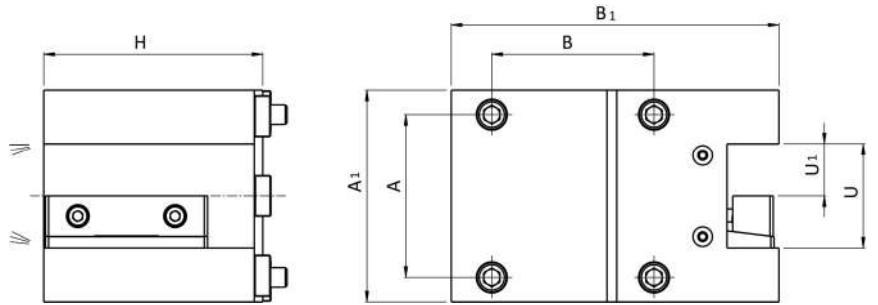

5/BMT85		Codice code - code - Bestell Nr.	D	d	H	H1	H2	L	L1	L2	A	B	A1	B1	A2	B2	M ₂ Nm	n ₂ 1	P kW
 90°	 DIN 6358	 -1 (1:1)	RRPFS 27 121UT85	85	Ø27	85	136,5	140	136	91,6	100	100	125	125			150	3200	15
			RRPFS 27 321UT85	85	Ø27	110	161,5	140	136	91,6	100	100	125	125				150	3200

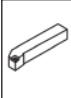



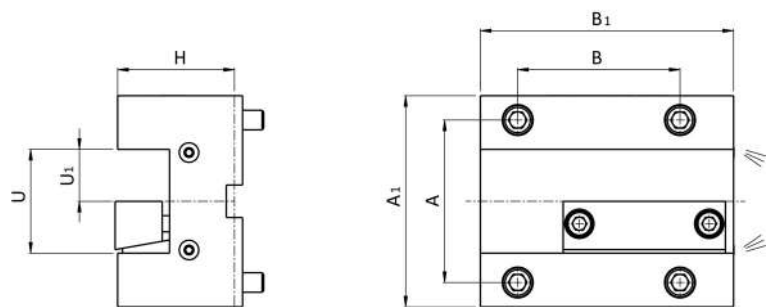

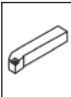
101/BMT85		Codice code - code - Bestell Nr.	U	U1	U2	H	H1	H2	H3	A	B	A1	B1	A2	B2	B3
 	E10/U 32 T85X135		64	32		135				100	100	130	202			
	E10/U 1.25" T85X135		2.5"	1.25"		135				100	100	130	202			

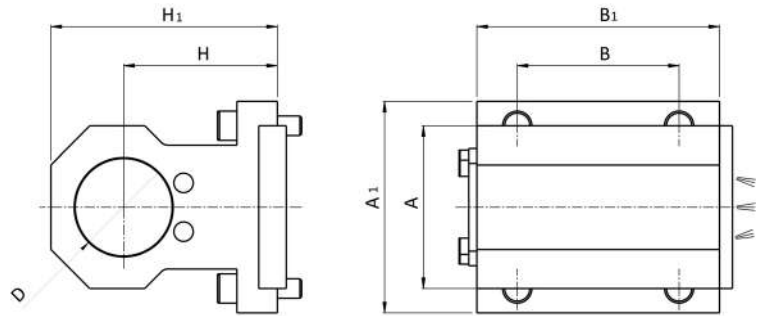

102/BMT85		Codice code - code - Bestell Nr.	U	U1	U2	H	H1	H2	H3	A	B	A1	B1	A2	B2	B3
 	E10/UA 32 T85X72		64	32		72				100	100	130	156			
	E10/UA 1.25" T85X72		2.5"	1.25"		72				100	100	130	156			



103/BMT85	Codice code - code - Bestell Nr.	d	d1	d2	H	H1	H2	H3	A	B	A1	B1	A2	B2	B3
	E10/B 60 T85X95	Ø 60			95	140			100	100	130	150			
 INT./EXT.	E10/B 2.5" T85X95	Ø 2.5"			95	140			100	100	130	150			

**La produzione:
il lavoro**

Production:
work

La produzione viene sviluppata nella moderna struttura a temperatura controllata di Almenno San Salvatore, mentre negli stabilimenti di Brembilla (I-Bergamo) vengono effettuate le lavorazioni di montaggio ed assemblaggio di gruppi completi. La superficie coperta delle strutture è di mq. 15.000, dei quali mq. 1.000 sono adibiti agli uffici amministrativi, commerciali e tecnici. L'attività produttiva si svolge con l'utilizzo di impianti e macchinari CNC costantemente aggiornati alle nuove tecnologie ed in grado di sviluppare le seguenti lavorazioni:

- Asportazione di truciolo
- Elettroerosione
- Tornitura orizzontale e verticale
- Fresatura universale 5 assi
- Fresatura/tornitura
- Lappatura per fori e piani
- Rettifica in tondo interno ed esterno
- Rettifica in tangenziale oltre al montaggio di gruppi e sottogruppi completi.

The production is developed in the modern, temperature controlled facility in Almenno San Salvatore, with Brembilla factories there are the assembly operations and the assembly of complete groups. The facilities covered area is of 15,000 sqm., 1,000 sqm. of which are used for the administrative commercial and technical offices. The production cycle takes place with the use of CNC fixtures and equipment constantly updated with new technologies and able to develop the following machining:

- Chip machining
- Electroerosion
- Horizontal and vertical turning
- 5-axis universal milling
- Milling/turning
- Lapping for holes and plane surfaces
- Cylindrical internal and external grinding
- Tangential grinding in addition to the assembly of complete groups and subassemblies.

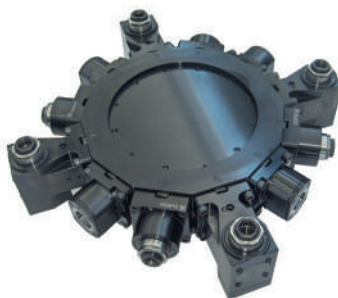
**Certificazioni:
uno standard
qualitativo**

Certification:
a quality
standard

La tecnologia avanzata svolge un ruolo chiave nell'obiettivo di incrementare il proprio valore, quello dei propri prodotti, dei servizi e della capacità del personale, operando nel rispetto delle norme UNI EN ISO 9001:2008 e ISO 14001:2004. L'alto livello di sensibilità verso il rispetto delle regole di sicurezza e dell'ambiente è presente ed immediatamente percepito in tutte le strutture aziendali.

Advanced technology plays a key role aiming to increase its value and the products, services and staff capacity value, operating in compliance with UNI EN ISO 9001:2008 and ISO 14001:2004.

The high level of sensitivity towards the observance of safety rules and the environment is present and perceived immediately in all facilities.



UNI EN ISO 9001:2008 - Cert. n° 0141



UNI EN ISO 14001:2004 - Cert. n° 0270A



ALGRA S.p.A. Divisione accessori
Via Manzoni, 41 24031 Almenno S. Salvatore (BG)
Tel. +39 035.64.20.51 • Fax +39 035.64.01.28
algra.accessori@algra.it - www.algra.it